



Illumination Switch

EX-ZM

Page 1 of 2

FEATURES

Impact resistant copper free aluminum enclosure.

Plastic-sprayed surface.

Explosion proof, dust tight and water tight.

Available as on/off switch and two-way control switch.

Two version of enclosure available.

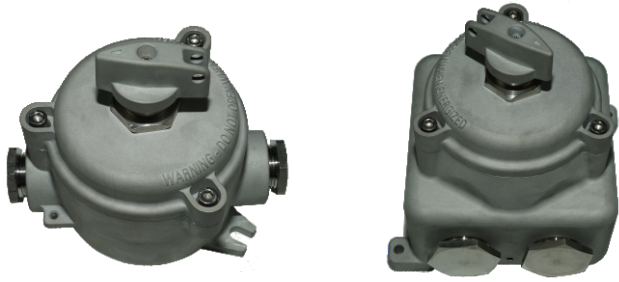

APPLICATION

Zone	ATEX / IECEx					
	0	1	2	20	21	22
For use in		x	x		x	x

Division	UL1203					
	Class I		Class II		Class III	
	1	2	1	2	1	2
For use in	x	x	x	x	x	x

ORDERING GUIDE

EX-ZM-	<input type="checkbox"/>	<input type="checkbox"/>	<input type="checkbox"/>
Explosion-proof Illumination Switch	Enclosure Type: A: Round; B: Square	Rated Current(A)	Switch Type: B: On/Off Switch; D: Two-way Control Switch

TECHNICAL DATA

Marking ATEX	II 2 G Ex db IIC T6 Gb II 2 D Ex tb IIIC T80°C Db IP66
Marking IECEx	Ex db IIC T6 Gb Ex tb IIIC T80°C Db IP66
Marking UL1203	Class I, Division 1, Groups B, C, D Class I, Division 2, Groups B, C, D Class II, Division 1, Groups E, F, G Class II, Division 2, Groups F, G Class III
Standard	EN60079-0, EN60079-1, EN60079-31, IEC60079-0, IEC60079-1, IEC60079-31
Rated Voltage	Max. 660VAC
Rated Current	16A, 25A
Ambient Temperature	-60°C to +60°C
Terminal	3 × (2.5-4)mm ²
Cable Entry	2 × M25×1.5 Stopping Plug; 2 × NPT3/4" Stopping Plug
Types of Flameproof Joint	Cylindrical Spigot Joints
Degree of Protection	IP66-IP67



Illumination Switch

EX-ZM

SPECIFICATION

Code	Rated Voltage/Current	Contact Drawing	Corresponding Switch																																				
EX-ZM-16B	250V/16A	<table border="1"> <tr> <td></td> <td>O</td> <td>I</td> <td>O</td> <td>I</td> <td></td> </tr> <tr> <td></td> <td>0°</td> <td>90°</td> <td>180°</td> <td>270°</td> <td></td> </tr> <tr> <td>1</td> <td></td> <td>×</td> <td></td> <td>×</td> <td>2</td> </tr> <tr> <td>3</td> <td></td> <td>×</td> <td></td> <td>×</td> <td>4</td> </tr> <tr> <td>5</td> <td></td> <td>×</td> <td></td> <td>×</td> <td>6</td> </tr> <tr> <td>7</td> <td></td> <td>×</td> <td></td> <td>×</td> <td>8</td> </tr> </table>		O	I	O	I			0°	90°	180°	270°		1		×		×	2	3		×		×	4	5		×		×	6	7		×		×	8	
	O	I	O	I																																			
	0°	90°	180°	270°																																			
1		×		×	2																																		
3		×		×	4																																		
5		×		×	6																																		
7		×		×	8																																		
EX-ZM-25B	250V/25A																																						
EX-ZM-16D	250V/16A	<table border="1"> <tr> <td></td> <td>O</td> <td>I</td> <td></td> </tr> <tr> <td></td> <td>0°</td> <td>90°</td> <td></td> </tr> <tr> <td>1</td> <td></td> <td>×</td> <td>2</td> </tr> <tr> <td></td> <td></td> <td>×</td> <td>4</td> </tr> <tr> <td>3</td> <td></td> <td>×</td> <td>6</td> </tr> <tr> <td></td> <td></td> <td>×</td> <td>8</td> </tr> </table>		O	I			0°	90°		1		×	2			×	4	3		×	6			×	8													
	O	I																																					
	0°	90°																																					
1		×	2																																				
		×	4																																				
3		×	6																																				
		×	8																																				
EX-ZM-25D	250V/25A																																						

Dimensional Drawing

Unit: mm/inch

EX-ZM-A

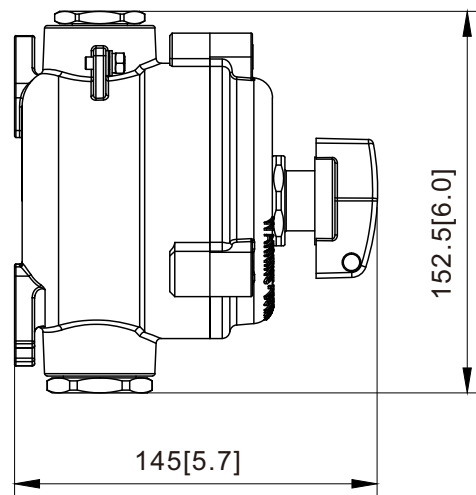
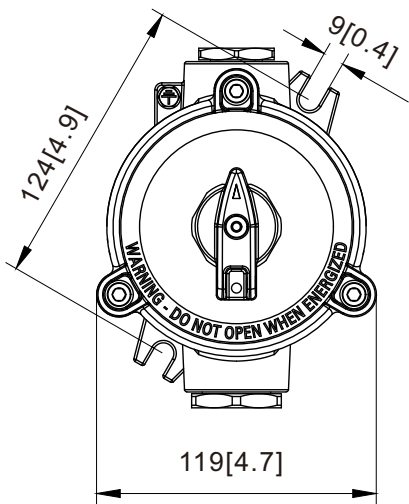

EX-ZM-B

